

250 CENTRIFUGAL PUMP SERIES

ABCO **ABCO - MIDDLE EAST FZE**

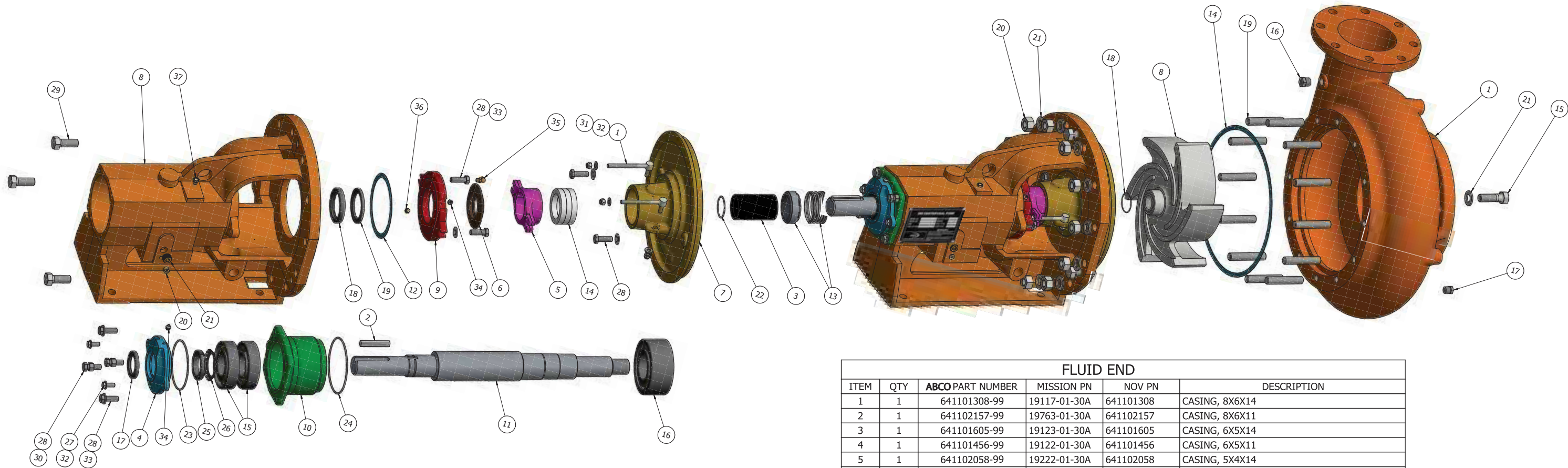

- PROVEN PERFORMANCE & DURABILITY -



POWER END					
ITEM	QTY	ABCO PART NUMBER	MISSION PN	NOV PN	DESCRIPTION
1	2	601102494-99	3701A	601102494	BOLT, GLAND ASSY
2	1	601212392-99	4372-5-20	601212392	KEY, 0.5 SQ X 3.0 LG
3	1	641102182-99	2094321A	641102182	SHAFT SLEEVE, STAINLESS STEEL
4	1	641103296-99	20617A	641103296	COVER, BEARING, OUTBOARD
5	1	641103338-99	20622A	641103338	GLAND ASSY, PACKING
6	1	641116108-99	22210-1A	641116108	DEFLECTOR
7	1	641116157-99	22223-03-30A	641116157	STUFFING BOX
8	1	644302499-99	20618-12-1	644302499	FRAME
9	1	644303109-99	20626A	641103361	COVER, INBOARD BEARING
10	1	644308504-99	20624-01-01	644308504	HOUSING, OUTBOARD BEARING
11	1	646490557-99	20612-02-33	646490557	SHAFT
12	1	648408706-99	20625	648408706	GASKET, INBOARD BEARING
13	1	648414308-99	22451	648414308	MECHANICAL SEAL, TUNGSTEN
14	1	661007005-99	25014-04M-B	661007005	PACKING, SHAFT
15	2	109-0204	20616-1	648408201S	BALL BEARING, ANGULAR CONTACT
16	1	109-0205	20615-1	648408102	BEARING, ANGULAR CONTACT, DOUBLE ROW
17	1	122-0267	20619-02	648408359	SEAL, RADIAL, .313 X 2.750 X 1.875
18	1	122-0268	20619-01	648408300	RADIAL SHAFT SEAL, 3.5 X 2.5 X .438
19	1	122-0269	20620-01	648408409	EXCLUSION SEAL, 3.5 X 2.5 X .25
20	1	126-0004	-	-	PLUG, HEX, SOCKET HEAD, 1/4 NPT
21	1	126-0402	-	-	PLUG, SOCKET HEAD, 1/2" NPT
22	1	129-0807	23444-01-72	648415156	O-RING, 2-136
23	1	129-0808	7496-26	72200017	O-RING, 2-248
24	1	129-0809	7496-253	648402295	O-RING, 2-253
25	1	134-1146	6123-4A	648402055	AN LOCK NUT, 11
26	1	134-1147	6124-4A	648402105	AN LOCK WASHER, 11
27	2	201-4215	-	-	CAPSCREW, HH, GR8, ZP, 3/8-16 UNC X 1 LG.
28	8	201-4393	-	-	CAPSCREW, HH, GR8, ZP, 1/2-13 UNC X 1.50 LG.
29	3	201-4675	-	-	CAPSCREW, HH, GR8, ZP, 3/4-10 UNC X 2 LG.
30	2	203-0165	-	-	NUT, HEX, GR8, ZP, 1/2-13 UNC
31	4	203-0824	-	-	NUT, LOCK, NYLON INS, GR8, ZP, 3/8-16 UNC
32	6	204-0113	-	-	WASHER, FLAT, SAE, ZP, 3/8
33	6	204-0115	-	-	WASHER, FLAT, SAE, ZP, 1/2
34	2	210-5011	-	-	ZERK, GREASE, 1/8NPT
35	1	210-5025	-	-	FITTING, GREASE, 90, 1/8 NPT
36	1	210-5096	-	-	FITTING, GREASE, RELIEF, 1/8" NPT
37	1	210-5133	-	-	FITTING, BREATHER, 1/8"

FLUID END					
ITEM	QTY	ABCO PART NUMBER	MISSION PN	NOV PN	DESCRIPTION
1	1	641101308-99	19117-01-30A	641101308	CASING, 8X6X14
2	1	641102157-99	19763-01-30A	641102157	CASING, 8X6X11
3	1	641101605-99	19123-01-30A	641101605	CASING, 6X5X14
4	1	641101456-99	19122-01-30A	641101456	CASING, 6X5X11
5	1	641102058-99	19222-01-30A	641102058	CASING, 5X4X14
6	1	641101902-99	19205-01-30A	641101902	CASING, 4X3X13
7	1	641101753-99	19203-01-30A	641101753	CASING, 3X2X13
8	1	19116-A0-30-99	19116-A0-30	-	IMPELLER, 8X6X14
9	1	19121-A0-30-99	19121-A0-30	-	IMPELLER, 6X5X14
10	1	19121-70-30-99	19121-70-30	-	IMPELLER, 6X5X11 & 8X6X11
11	1	19224-A0-30-99	19224-A0-30	-	IMPELLER, 5X4X14
12	1	19206-90-30-99	19206-90-30	-	IMPELLER, 4X3X13
13	1	19204-90-30-99	19204-90-30	-	IMPELLER, 3X2X13
14	1	648403012-99	10399-46-1	648403012	GASKET, CASING
15	1	201-4677	-	-	CAPSCREW, HH, GR8, ZP, 3/4-10 UNC X 2.50 LG.
16	1	126-0333	-	-	PLUG, HEX HEAD, 1/2" MNPT
17	1	126-0397	-	-	3/8" NPT PLUG HEX HEAD
18	1	129-0806	19110-72	648405082	O-RING, 2-032
19	12	200-2120	3862-76	648401115	STUD, ALL THREAD, BLK, 3/4-10 UNC X 4 LG.
20	12	203-0232	3932-61	64840214	NUT, HEAVY HEX, ZP, 3/4-10 UNC
21	13	204-0118	-	-	WASHER, FLAT, SAE, ZP, 3/4

PROVEN PERFORMANCE & DURABILTIY...

Introducing the new Abco Middle East FZE 250 series centrifugal pump. Engineered for durable performance, these centrifugal pumps are suitable for a variety of pumping applications including:

- Triplex Supercharging
- Liner Washing
- General Charging
- Water Pumping
- Mud Hopper & Guns
- Trip Tank
- Degasser
- Mud Cleaner

Key Features include:

- ✓ Heavy-duty, cast iron frame to withstand high pumping loads
- ✓ Robust concentric housing which prevents vibration, turbulence, and cavitation
- ✓ Utilizes angular contact bearings for maximum durability
- ✓ Stainless steel shaft sleeve to protect shaft from abrasive fluids
- ✓ Available with a tungsten-tungsten mechanical seal.
- ✓ Standard with rope packing for adjustable secondary leak prevention.

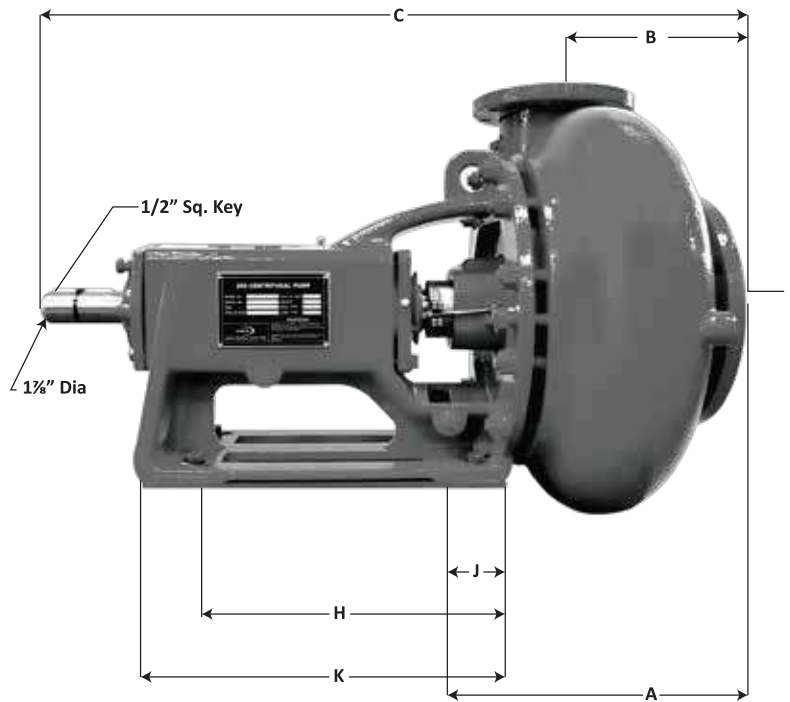
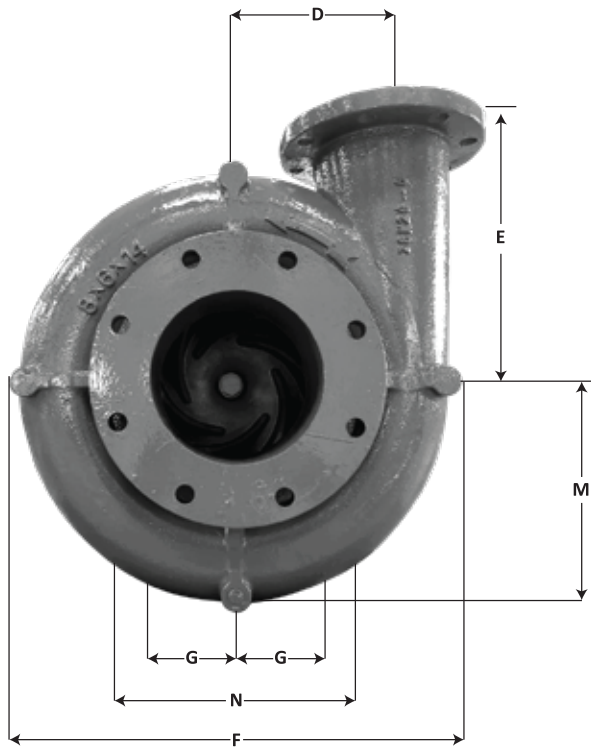

PEDESTAL, HOUSING & INSTALLATION DIMENSIONS

SIZE	A	B	C	D	E	F	G	H	J	K	M	N	Max. Imp Diam	Min. Imp Diam	Suc on Size	Discharge Size	Weight KG
3x2x13	8 ³ / ₄	3 ³ / ₄	33	7	10 ¹ / ₄	17 ⁷ / ₈	3 ¹ / ₂	15 ⁵ / ₁₆	2 ⁵ / ₁₆	20 ¹ / ₄	9	9	13	6	3	2	195
4x3x13	9 ³ / ₈	4 ¹ / ₄	33 ⁵ / ₈	6 ¹ / ₄	10 ¹ / ₄	17 ⁷ / ₈	3 ¹ / ₂	15 ⁵ / ₁₆	2 ⁵ / ₁₆	20 ¹ / ₄	9	9	13	6	4	3	200
5x4x14	10 ³ / ₄	5	35	6 ³ / ₈	11	19	3 ¹ / ₂	15 ⁵ / ₁₆	2 ⁵ / ₁₆	20 ¹ / ₄	9	9	14	7	5	4	222
6x5x11	12 ¹ / ₁₆	5 ³ / ₄	36 ³ / ₈	6	11	17 ⁷ / ₈	3 ¹ / ₂	15 ⁵ / ₁₆	2 ⁵ / ₁₆	20 ¹ / ₄	9	9	11	8	6	5	236
6x5x14	12 ¹ / ₁₆	5 ³ / ₄	36 ³ / ₈	6	11	21	3 ¹ / ₂	15 ⁵ / ₁₆	2 ⁵ / ₁₆	20 ¹ / ₄	9	9	14	10	6	5	249
8x6x11	13 ³ / ₄	6 ³ / ₄	37 ¹ / ₂	8 ³ / ₈	14	20	3 ¹ / ₂	15 ⁵ / ₁₆	2 ⁵ / ₁₆	20 ¹ / ₄	9	9	11	8	8	6	277
8x6x14	13 ³ / ₄	6 ³ / ₄	37 ¹ / ₂	8 ³ / ₈	14	23	3 ¹ / ₂	15 ⁵ / ₁₆	2 ⁵ / ₁₆	20 ¹ / ₄	9	9	14	10	8	6	286

* All dimension are in Inches.



ABCO - MIDDLE EAST FZE

P.O. Box 17235, Jebel Ali, Dubai - U.A.E.

Tel : + 971 4 880 6535, Fax: + 971 4 880 6536

E-mail : abco_me@eim.ae, Web : www.abco-me.com